

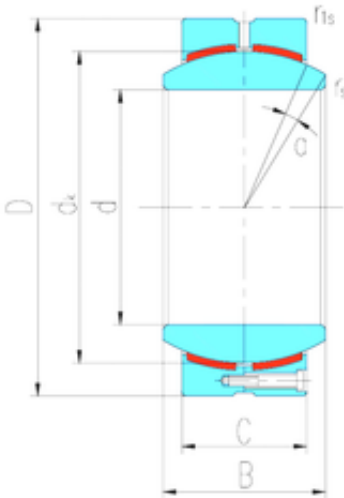

CSC BEARING GROUP limited



360 mm x 480 mm x 160 mm LS GEC360HC
sliding bearing

Bearing No. GEC360HC

Size	360x480x160 mm
Bore Diameter	360 mm
Outer Diameter	480 mm
Width	160 mm
d	360 mm
D	480 mm
B	160 mm
C	135 mm
dk	420 mm
r min.	1,1 mm
r1 min.	3 mm
Angle	3 °
Weight	87 Kg
Basic dynamic load rating (C)	5670 kN

GEC360HC Bearing 2D drawings and 3D CAD models