

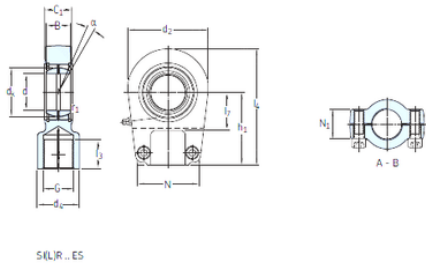

# CSC BEARING GROUP limited



## SKF SIR 120 ES sliding bearing

Bearing No. SIR 120 ES

SIR 120 ES Bearing 2D drawings and 3D CAD models

Bore Diameter	120 mm
d	120 mm
d2 max.	343 mm
d4 max.	175 mm
dk	160 mm
h1	310 mm
l3 min.	135 mm
l4 max.	493 mm
l7 min.	138 mm
r1 min.	1 mm
B	85 mm
C1 max	90,5 mm
N max	257 mm
N1 max	86 mm
Thread (G)	M 130x3 Tolerance 6H
Angle	6 °
Weight	84 Kg
Basic dynamic load rating (C)	950 kN
Category	Bearings
Inventory	0.0
Manufacturer Name	SKF
Minimum Buy Quantity	N/A
Weight / Kilogram	90
Product Group	B04286
d <sub>2</sub> max.	343 mm
G	M 130x3



## CSC BEARING GROUP limited

$C_1$ max.	90.5 mm
$h_1$	310 mm
	6 °
$d_k$	160 mm
$d_4$ max.	175 mm
$l_3$ min.	135 mm
$l_4$ max.	493 mm
$l_7$ min.	138 mm
N max.	257 mm
$N_1$ max.	86 mm
$r_1$ min.	1 mm
Size bolt with internal hexagon	M 24
Tightening torque bolt with internal hexagon	670 N · m
Basic dynamic load rating C	950 kN
Basic static load rating $C_0$	2450 kN
Specific dynamic load factor K	100 N/mm <sup>2</sup>
Material constant $K_M$	330
Mass rod end	76.6 kg