

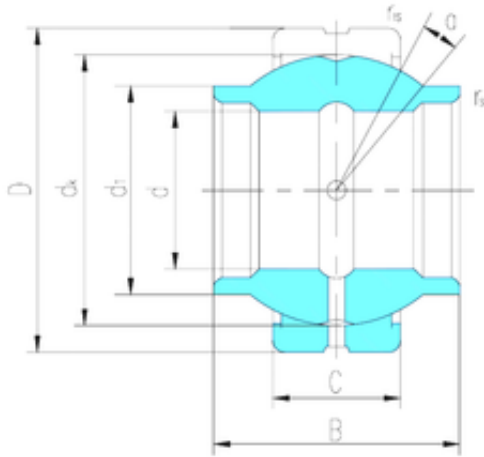

CSC BEARING GROUP limited



35 mm x 55 mm x 35 mm LS GEEM35ES-2RS
sliding bearing

Bearing No. GEEM35ES-2RS

Size	35x55x35 mm
Bore Diameter	35 mm
Outer Diameter	55 mm
Width	35 mm
d	35 mm
D	55 mm
B	35 mm
C	20 mm
d1	40 mm
dk	47 mm
r min.	0,6 mm
r1 min.	1 mm
Angle	4 °
Weight	0,25 Kg
Basic dynamic load rating (C)	79 kN

GEEM35ES-2RS Bearing 2D drawings and 3D CAD models