

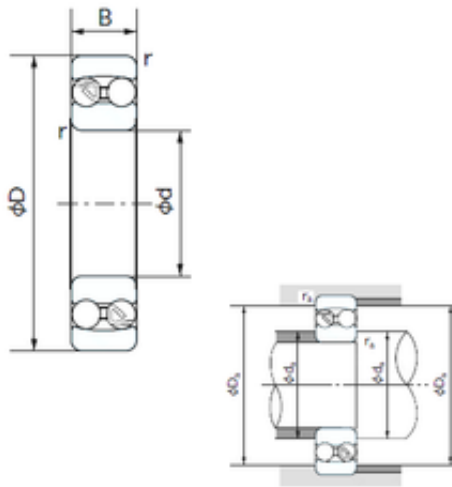

CSC BEARING GROUP limited



100 mm x 215 mm x 73 mm NACHI 2320 Self aligning ball bearing

Bearing No. 2320

2320 Bearing 2D drawings and 3D CAD models

Size	100x215x73 mm
Bore Diameter	100 mm
Outer Diameter	215 mm
Width	73 mm
d	100 mm
D	215 mm
B	73 mm
C	73 mm
r1 min.	3 mm
da min.	114 mm
Da max.	201 mm
ra max.	2.5 mm
Weight	12.5 Kg
Basic dynamic load rating (C)	192 kN
Basic static load rating (C0)	79 kN
(Grease) Lubrication Speed	2400 r/min
(Oil) Lubrication Speed	3000 r/min
Calculation factor (e)	0.37
Calculation factor (Y0)	1.8
Calculation factor (Y1)	1.7