

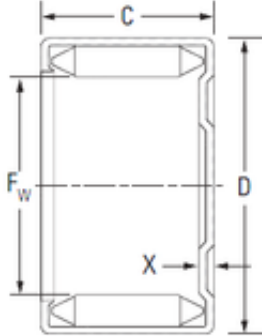

CSC BEARING GROUP limited

KOYO M14121 Needle bearing



Bearing No. M14121

Size	22.225x28.575x19.050 mm
Bore Diameter	22.225 mm
Outer Diameter	28.575 mm
Width	19.050 mm
Fw	22.225 mm
D	28.575 mm
C	19.050 mm
x	2.29 mm
b	16.5 mm
Weight	0,032 Kg
Basic dynamic load rating (C)	20.1 kN
Basic static load rating (C0)	44.6 kN

M14121 Bearing 2D drawings and 3D CAD models