

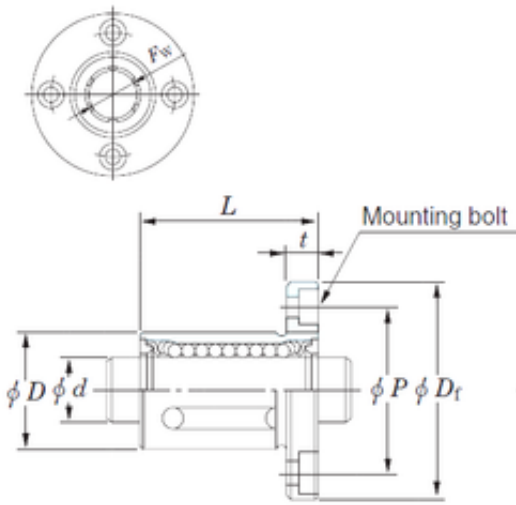

CSC BEARING GROUP limited

KOYO SDMF20 Linear bearing

Bearing No. SDMF20



SDMF20 Bearing 2D drawings and 3D CAD models

Bore Diameter	20 mm
Outer Diameter	32 mm
Fw	20 mm
D	32 mm
P	43 mm
t	8 mm
D1	54 mm
K	42 mm
L	42 mm
Bolt (G)	M5
Weight	170 Kg
Basic dynamic load rating (C)	590 kN