

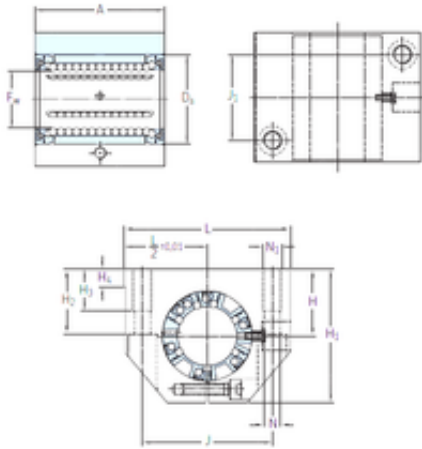

CSC BEARING GROUP limited



SKF LUNE 40-2LS Linear bearing

Bearing No. LUNE 40-2LS

Bore Diameter	40 mm
Fw	40 mm
H4	11 mm
H3	26 mm
Da	62 mm
A	80 mm
H	45 mm
H1	90 mm
H2	44 mm
J	86 mm
L	108 mm
N	10,5 mm
J1	58 mm
Thread (N1)	M12
Weight	1,44 Kg
Basic dynamic load rating (C)	7,8 kN

LUNE 40-2LS Bearing 2D drawings and 3D CAD models