

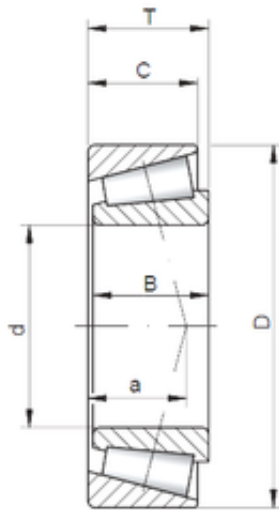

CSC BEARING GROUP limited



66,675 mm x 122,238 mm x 38,354 mm ISO
HM212049/10 Double knee bearing

Bearing No. HM212049/10

Size	66.675x122.238x38.1 mm
Bore Diameter	66,675 mm
Outer Diameter	122,238 mm
Width	38,1 mm
d	66,675 mm
D	122,238 mm
T	38,1 mm
B	38,354 mm
C	29,718 mm
a	10,9 mm

HM212049/10 Bearing 2D drawings and 3D CAD models