

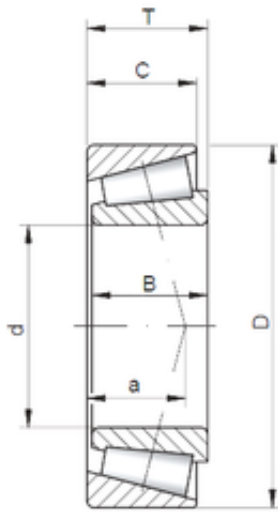

CSC BEARING GROUP limited



70 mm x 110 mm x 25 mm ISO JLM813049/10
Double knee bearing

Bearing No. JLM813049/10

Size	70x110x26 mm
Bore Diameter	70 mm
Outer Diameter	110 mm
Width	26 mm
d	70 mm
D	110 mm
T	26 mm
B	25 mm
C	20,5 mm
a	0,3 mm

JLM813049/10 Bearing 2D drawings and 3D CAD models