

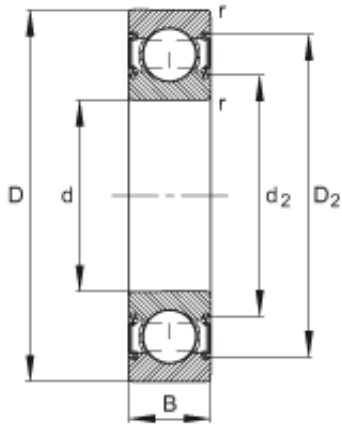

CSC BEARING GROUP limited



15 mm x 35 mm x 11 mm FAG 6202-C-2HRS
Deep ball bearings

Bearing No. 6202-C-2HRS

6202-C-2HRS Bearing 2D drawings and 3D CAD models

| | |
|----------------|---------------------------------------|
| Size | 15x35x11 mm |
| Bore Diameter | 15 mm |
| Outer Diameter | 35 mm |
| Width | 11 mm |
| d | 15 mm |
| D | 35 mm |
| B | 11 mm |
| D_2 | 31,2 mm |
| $D_{a \max}$ | 30,8 mm |
| d_2 | 19,8 mm |
| $d_{a \min}$ | 19,2 mm |
| $r_{a \max}$ | 0,6 mm |
| r_{\min} | 0,6 mm |
| m | 0,045 kg / Weight |
| C_r | 8400 N / Dynamic load rating (radial) |
| C_{0r} | 3750 N / Static load rating (radial) |
| n_G | 19300 1/min / Limiting speed |