

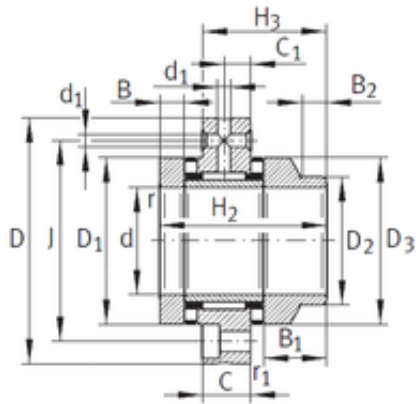

# CSC BEARING GROUP limited

## 60 mm x 150 mm x 17,5 mm INA ZARF60150-L-TV Compound bearing



Bearing No. ZARF60150-L-TV

ZARF60150-L-TV Bearing 2D drawings and 3D CAD models

Size	60x150x22.5 mm
Bore Diameter	60 mm
Outer Diameter	150 mm
Width	22,5 mm
d	60 mm
D	150 mm
C	22,5 mm
H3	72 mm
d1	6 mm
r min.	0,3 mm
r1 min.	0,6 mm
B	17,5 mm
B1	38,5 mm
B2	16 mm
C1	12,5 mm
D1	105 mm
D2	90 mm
D3	105 mm
H2	103 mm
J	123 mm
da min.	88 mm
Da max.	106 mm
Weight	5,35 Kg
Dynamic load rating radial (C)	44,5 kN
Dynamic load rating axial	187 kN



## CSC BEARING GROUP limited

(C)	
Static load rating radial (C0)	92 kN
Static load rating axial (C0)	550 kN
(Grease) Lubrication Speed	950 r/min
Category	Ball Bearings
Inventory	0.0
Manufacturer Name	SCHAEFFLER GROUP
Minimum Buy Quantity	N/A
Weight / Kilogram	6.407
EAN	4012802469554
Product Group	B00234