

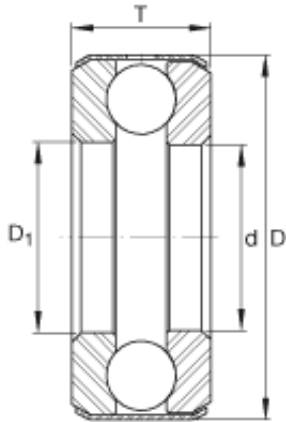

# CSC BEARING GROUP limited



## INA B5 Ball bearing

Bearing No. B5

Size	19.05x37.313x15.88 mm
Bore Diameter	19,05 mm
Outer Diameter	37,313 mm
Width	15,88 mm
d	3/4 inch
d	19,05 mm
D	1,469 inch
D	37,313 mm
T	0,625 inch
T	15,88 mm
D <sub>1</sub>	0,781 inch
m	0,174 lbs / Weight
m	0,079 kg / Weight
C <sub>a</sub>	4250 lbf / Dynamic load rating (axial)
C <sub>a</sub>	18900 N / Dynamic load rating (axial)
C <sub>0a</sub>	7300 lbf / Static load rating (axial)
C <sub>0a</sub>	32500 N / Static load rating (axial)
Category	Thrust Ball Bearing
Inventory	0.0
Manufacturer Name	SCHAEFFLER GROUP
Minimum Buy Quantity	N/A
Weight / Kilogram	0.08
EAN	4012802308242

B5 Bearing 2D drawings and 3D CAD models



## CSC BEARING GROUP limited

Product Group	B00308
Rolling Element	Ball Bearing
Thrust Bearing	Yes
Single or Double Direction	Single Direction
Banded	Yes
Precision Class	ABEC 1   ISO P0
Component Description	Roller Assembly Plus Raceways
Other Features	Single Row   Deep Groove   Medium Cross Section   Grooved Race   Non Separable   Full Complement   Standard Oil Hole in Band
Long Description	3/4" Bore 1; 25/32" Bore 2; 1-15/32" Outside Diameter; 5/8" Height; Ball Bearing; Single Direction; Banded; ABEC 1   ISO P0 Precision
Inch - Metric	Inch
Category	Thrust Ball Bearings
UNSPSC	31171507
Harmonized Tariff Code	8482.10.50.08
Noun	Bearing
Keyword String	Ball Thrust
Manufacturer URL	<a href="http://www.ina.com">http://www.ina.com</a>
Manufacturer Item Number	B5HLG
Weight / LBS	0.174
Overall Height with Aligning Washer	0 Inch   0 Millimeter
Height	0.625 Inch   15.875 Millimeter
Bore 1	0.75 Inch   19.05 Millimeter
Bore 2	0.781 Inch   19.837 Millimeter
Outside Diameter	1.469 Inch   37.313



# CSC BEARING GROUP limited

	Millimeter
--	------------