

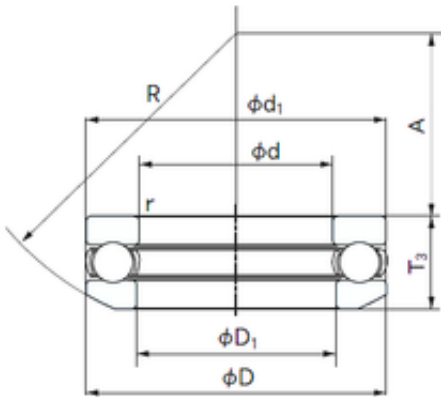

CSC BEARING GROUP limited

NACHI 53244 Ball bearing

Bearing No. 53244



53244 Bearing 2D drawings and 3D CAD models

Size	220x300x65.6 mm
Bore Diameter	220 mm
Outer Diameter	300 mm
Width	65.6 mm
d	220 mm
D	300 mm
T	65.6 mm
d1	297 mm
r min.	2 mm
A	118 mm
D1	224 mm
R	225 mm
Weight	13.0 Kg
Basic dynamic load rating (C)	325 kN
Basic static load rating (C0)	1210 kN
(Grease) Lubrication Speed	690 r/min