

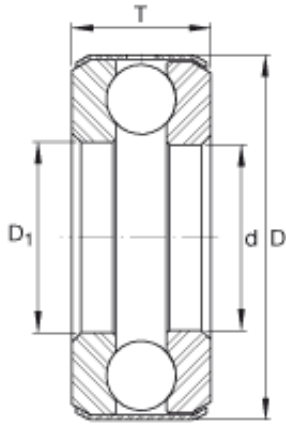

CSC BEARING GROUP limited



INA B18 Ball bearing

Bearing No. B18

B18 Bearing 2D drawings and 3D CAD models

Size	39.688x65.89x19.05 mm
Bore Diameter	39,688 mm
Outer Diameter	65,89 mm
Width	19,05 mm
d	1 9/16 inch
d	39,688 mm
D	2,594 inch
D	65,89 mm
T	0,75 inch
T	19,05 mm
D ₁	1,594 inch
m	0,54 lbs / Weight
m	0,245 kg / Weight
C _a	9800 lbf / Dynamic load rating (axial)
C _a	43600 N / Dynamic load rating (axial)
C _{0a}	21400 lbf / Static load rating (axial)
C _{0a}	95000 N / Static load rating (axial)
Category	Thrust Ball Bearing
Inventory	0.0
Manufacturer Name	SCHAEFFLER GROUP
Minimum Buy Quantity	N/A
Weight / Kilogram	0.25
EAN	4054364115517



CSC BEARING GROUP limited

Product Group	B00308
Rolling Element	Ball Bearing
Thrust Bearing	Yes
Single or Double Direction	Single Direction
Banded	Yes
Precision Class	ABEC 1 ISO P0
Component Description	Roller Assembly Plus Raceways
Other Features	Single Row Deep Groove Medium Cross Section Grooved Race Non Separable Full Complement Standard Oil Hole in Band
Long Description	1-9/16" Bore 1; 1-19/32" Bore 2; 2-19/32" Outside Diameter; 3/4" Height; Ball Bearing; Single Direction; Banded; ABEC 1 ISO P0 Precision
Inch - Metric	Inch
Category	Thrust Ball Bearings
UNSPSC	31171507
Harmonized Tariff Code	8482.10.50.08
Noun	Bearing
Keyword String	Ball Thrust
Manufacturer URL	http://www.ina.com
Manufacturer Item Number	B18
Weight / LBS	0.54
Bore 1	1.563 Inch 39.7 Millimeter
Bore 2	1.594 Inch 40.488 Millimeter
Outside Diameter	2.594 Inch 65.888 Millimeter
Overall Height with Aligning Washer	0 Inch 0 Millimeter



CSC BEARING GROUP limited

Height	0.75 Inch 19.05 Millimeter
--------	------------------------------